

## Impervious U-Drape

Suresafe Impervious U-Drapes create an impervious barrier to fluid strikethrough. They are designed to act as a protective covering to isolate a surgical site from contamination. The U-Drape has a U-shaped fenestration on one end and an adhesive area of 20cm x 76cm.



### Strong and Durable

Made from low linting, abrasion resistant and impervious material to aid in infection control



### Adhesive Area

Adhesive area ensures drape remains in place during use



### Conformable

Conforms easily to the shape of the surgical site

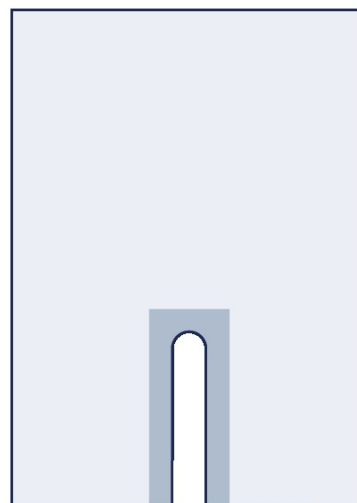

### Suitable for:

- Operating theatres
- Emergency departments
- Procedure packs

REF	Size	Colour	Sterility	Pcs/Unit	Units/Ctn
<b>S72523</b>	152 x 213cm	Blue	Sterile	30	1

At Sentry, we are dedicated to upholding sustainable principles to safeguard our planet, people, and future, and we strive to consistently act responsibly in doing so.

